

3-POINT HITCH ATTACHMENT - HITCH-3B

APPROX WEIGHT: 9.58 lbs.
 DOES NOT INCLUDE WEIGHT OF POWER OR PACKAGING!!!

*** ANY ADDITIONS, DELETIONS, OR OMISSIONS MUST BE CORRECTED ON THIS DRAWING AS THIS DRAWING WILL BE CONSIDERED ALL INCLUSIVE ***

ALL GRAPHICS PROVIDED ARE FOR REFERENCE ONLY. IF CERTAIN DIMENSIONS ARE CRITICAL PLEASE VERIFY THOSE DIMENSIONS WITH YOUR SALESPERSON

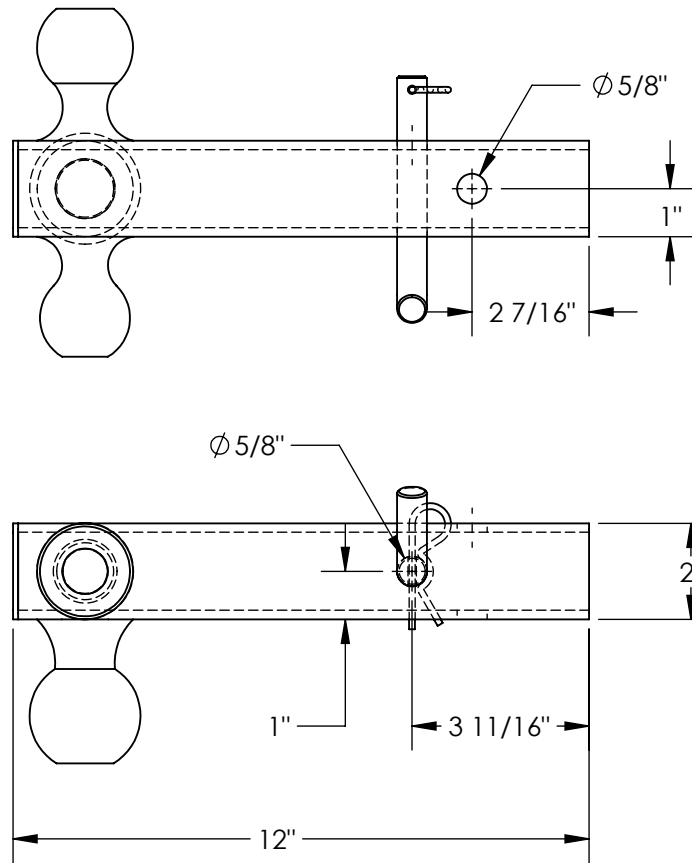

SHIPS WITH HITCH PIN 99-112-030
VESTIL ADDS PIN WHEN WE SHIP UNIT

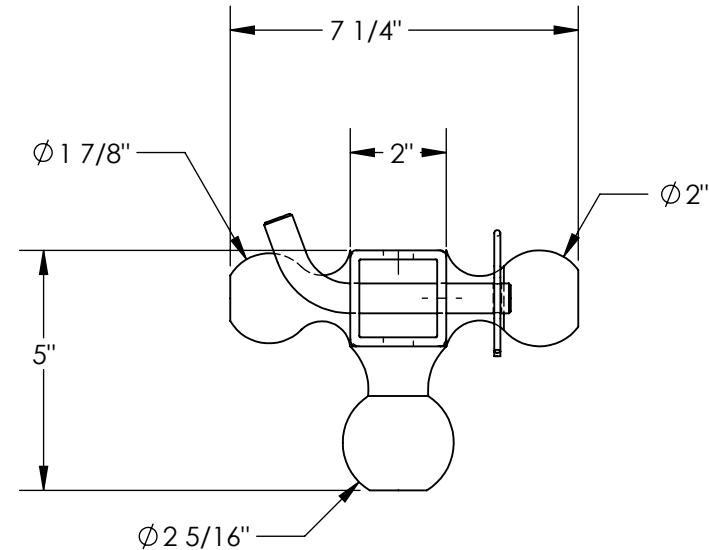

DIMENSION TOLERANCE $\pm 1/4"$

SPECIAL FEATURES

NONE

STANDARD FEATURES

MODEL NUMBER IS HITCH-3B
 OVERALL WIDTH IS $71/4"$
 OVERALL LENGTH IS $12"$
 OVERALL HEIGHT IS $5"$
 CAPACITY OF $\phi 17/8"$ BALL IS 2,000 LBS.
 CAPACITY OF $\phi 2"$ BALL IS 3,500 LBS.
 CAPACITY OF $\phi 25/16"$ BALL IS 7,500 LBS.

APPROVAL	I, THE UNDERSIGNED, AGREE THAT THE PRODUCT AS REPRESENTED SATISFIES DESIGN AND DIMENSION REQUIREMENTS. I ALSO ACKNOWLEDGE MY DUTY TO CONFIRM PRODUCT AND INSTALLATION COMPLIANCE WITH ALL APPLICABLE FEDERAL, STATE AND LOCAL REGULATIONS AND STANDARDS.	
	ANY MODIFIED UNITS ARE NON-RETURNABLE	
	[] As drawn [] As marked	
	Signed: _____ Date: _____	
Printed Name: _____		
LEAD TIME WILL START UPON RECEIPT OF SIGNED APPROVAL DRAWING		

FOR INTERNAL USE ONLY PROJECT SIGN OFF	
SALES	
ENG.	
FAB.	
POWER	

DISTRIBUTOR'S NAME:		P.O.#
VESTIL MANUFACTURING		X
DRAWN BY: C. ACKERMAN		DATE: 04/07/12
REFERENCE: X		SCALE: 1:4
QUOTED LEAD TIME: X		QUOTE #
		X
		FILE NAME:
		99-007-007